

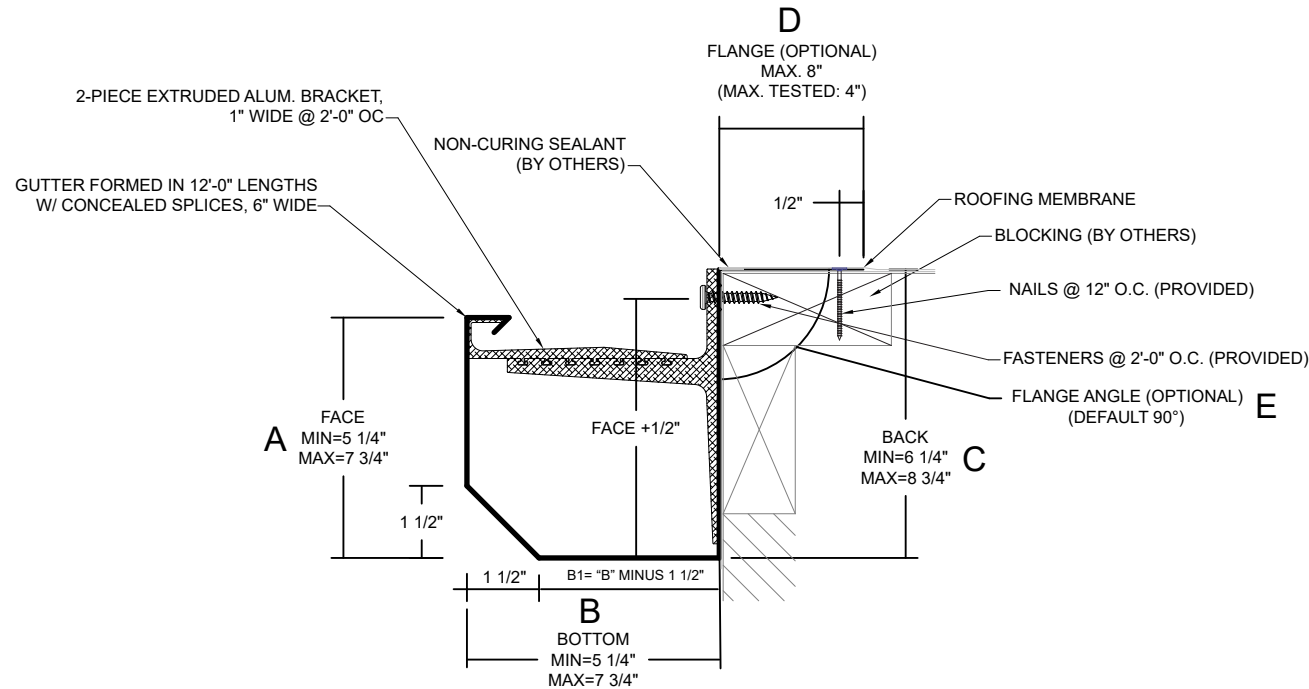

# GUTTER CHAMFER

## \*NOTES

- Bottom sizes are provided in 1/2" increments
- Maximum downspout dimension not to exceed "B" minus 2-1/16"
- Roof flange is optional. If flange size is not provided, the gutter will not include a roof flange. If flange angle is not provided, the gutter will have a 90-degree flange.
- Pop rivets provided
- Unless otherwise noted, fabrication of miters and accessories are provided with a non-penetrating quicklock joint, then factory sealed watertight
- Welded accessories require minimum material thickness of .050 aluminum.
- For non-90 miters, see separate print approval
- Product should be installed per provided installation instructions
- ANSI/SPRI GT-1 Test Pressure up to 223 psf (Horizontal) and 136 psf (Vertical)



## APPROVALS\*

**ANSI/SPRI/GT-1**  
Test Pressures listed in notes

## PROJECT INFO

Project Name: \_\_\_\_\_

Architect: \_\_\_\_\_

Roofing Contractor: \_\_\_\_\_

### Project Type:

By selecting this box you have verified and confirmed that dimensions, sizes, and quantities are correct. All products will be installed in strict accordance with printed instructions.

SHT# \_\_\_\_\_ of \_\_\_\_\_

DATE: **03/21/ 24**

Date: \_\_\_\_\_

DRN BY: **PL**

CKD BY: **MM**

DWG #: 52012-42337

REV: **A**

## DIMENSIONS

SELECT SIZE	A (FACE)	B (BOTTOM)	C (BACK)	FLANGE (OPTIONAL)
<input type="checkbox"/>	5 1/4"	5 1/4"	6 1/4"	<b>D (FLANGE SIZE)</b> (MAX 8"/MAX TESTED 4") NOTE: IF SIZE IS NOT PROVIDED, GUTTER WILL NOT INCLUDE A ROOF FLANGE
<input type="checkbox"/>	5 3/4"	5 3/4"	6 3/4"	
<input type="checkbox"/>	6 1/4"	6 1/4"	7 1/4"	
<input type="checkbox"/>	6 3/4"	6 3/4"	7 3/4"	
<input type="checkbox"/>	7 1/4"	7 1/4"	8 1/4"	
<input type="checkbox"/>	7 3/4"	7 3/4"	8 3/4"	<b>E (FLANGE ANGLE)</b> NOTE: IF ANGLE IS NOT PROVIDED, FLANGE WILL BE 90°

## MATERIAL

24 Ga. Galv. Steel  
 22 Ga. Galv. Steel  
 .040" Aluminum  
 .050" Aluminum  
 .063" Aluminum  
 OTHER: \_\_\_\_\_

Color: \_\_\_\_\_

Finish: \_\_\_\_\_

Substrate:

If substrate is not given, wood fasteners will be provided.

Wood  
 Masonry  
 Metal

## QUANTITIES

\_\_\_\_\_ Lineal Feet (12'-0" Lengths)

\_\_\_\_\_ Outside Miter (90°)

\_\_\_\_\_ Inside Miter (90°)

\_\_\_\_\_ Right Endcaps

\_\_\_\_\_ Left Endcaps

\_\_\_\_\_ Expansion Joints (If Required)

Accessory Type\*:  Quicklock (Default)  Welded (Surcharge)

**Mule-Hide Products**  
 1195 Prince Hall Drive  
 Beloit, WI 53511  
 800-786-1492  
 www.mulehide.com  
 To submit a quote request, please contact your local TM or email mhquotes@metalera.com.



# GUTTER

## CHAMFER STANDARD ACCESSORIES

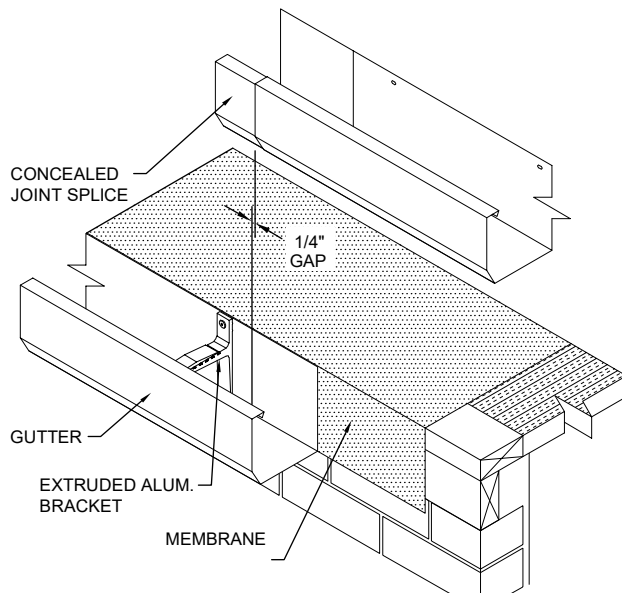

CONCEALED  
JOINT SPLICE

1/4"  
GAP

GUTTER

EXTRUDED ALUM.  
BRACKET

MEMBRANE

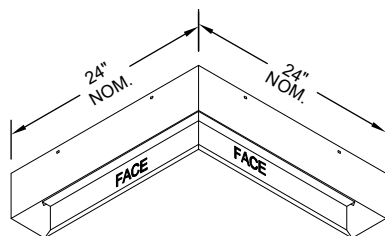

INSIDE MITER

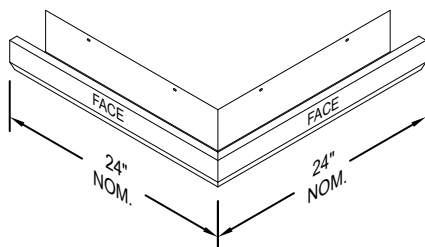

OUTSIDE MITER

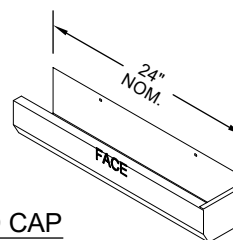

END CAP  
LEFT HAND SHOWN

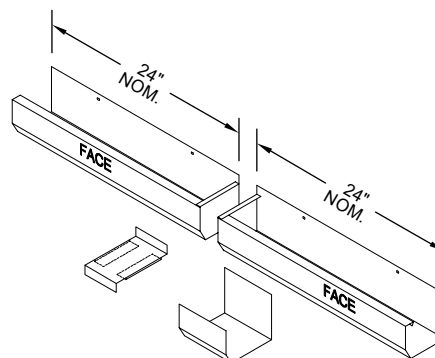

EXPANSION JOINT  
(IF REQUIRED)

Standard gutter miter leg lengths are 24" Nominal  
Standard gutter miter angle is 90°  
For special miter requirements, attach sketches or consult manufacturer for assistance.

**Mule-Hide Products**  
1195 Prince Hall Drive  
Beloit, WI 53511  
800-786-1492  
www.mulehide.com  
To submit a quote request, please  
contact your local TM or email  
mhquotes@metalera.com.

SHT# \_\_\_\_ of \_\_\_\_

DATE: **03/21/ 24**

DRN BY: **PL**

CKD BY: **MM**

DWG #: **52012-42337**

REV: **A**