



SNAP COPING

EXISTING SLOPE

* NOTES

- Oil canning can occur on larger face heights and wall widths; recommend 22 Ga., .050" or .063" Aluminum for face height over 8" or wall width over 12".

- 24 Ga. and .040" Aluminum covers available for wall sizes 3.5" to 24" ONLY

- Unless otherwise noted, fabrication of miters and accessories are furnished standard utilizing a non-penetrating quicklock joint, then factory sealed watertight

- Welded accessories require a minimum material thickness of .050" Aluminum

- For non-90 miters, see separate print approval

- Product should be installed per provided installation instructions

- ANSI/SPRI/FM 4435/ES-1 test pressures up to 226 psf (Horizontal) and 391 psf (Vertical)

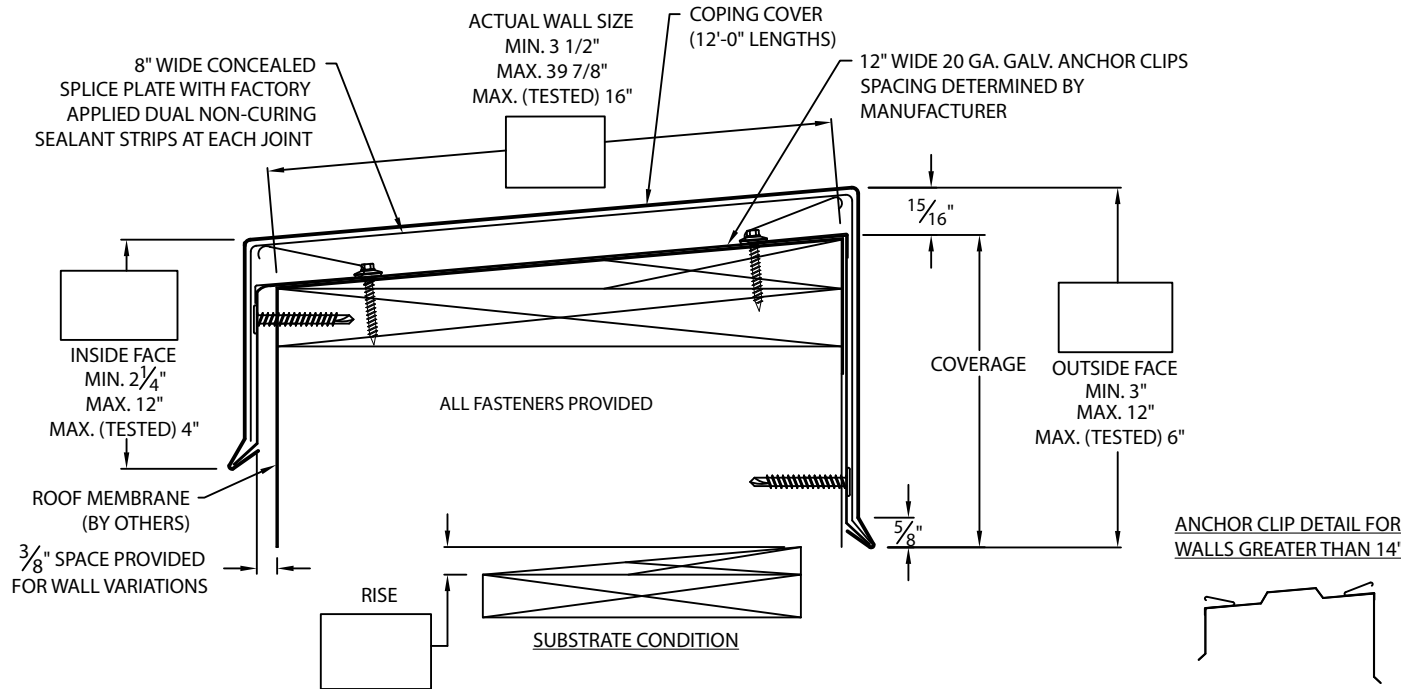

PROJECT INFO

Project Name: _____

Architect: _____

Roofing Contractor: _____

Project Type:

By selecting this box you have verified and confirmed that dimensions, sizes, and quantities are correct. All products will be installed in strict accordance with printed instructions.

Date: _____

Mule-Hide Products
1195 Prince Hall Drive
Beloit, WI 53511
800-786-1492
www.mulehide.com

To submit a quote request, please contact your local TM or email mhquotes@metalera.com.

SHT# _____ of _____

DATE: **03/21/24**

DRN BY: **JJC**

CKD BY: **MM**

DWG #: 52011-42334

REV: **A**

APPROVALS*

ANSI/SPRI/FM 4435/ES-1
Test Pressures listed in notes

MATERIAL*

- | | |
|---|---|
| <input type="checkbox"/> 24 Ga. Galv. Steel | Color: _____ |
| <input type="checkbox"/> 22 Ga. Galv. Steel | Finish: _____ |
| <input type="checkbox"/> .040" Aluminum | Substrate: (For Top Fasteners) |
| <input type="checkbox"/> .050" Aluminum | if substrate is not given, wood fasteners will be provided. |
| <input type="checkbox"/> .063" Aluminum | <input type="checkbox"/> Wood |
| <input type="checkbox"/> OTHER: _____ | <input type="checkbox"/> Masonry |
| | <input type="checkbox"/> Metal |

QUANTITIES

Accessory Type* : Quicklock (Default) Welded (Surcharge)

_____ Lineal Feet (12'-0" Lengths)

_____ Outside Miter (90°)

_____ Inside Miter (90°)

_____ Right Endcaps

_____ Left Endcaps

_____ Right Endwall Flashing (Coping Version)

_____ Left Endwall Flashing (Coping Version)

_____ Right Endwall Flashing (Splice Plate Version)

_____ Left Endwall Flashing (Splice Plate Version)



SNAP COPING

STANDARD ACCESSORIES

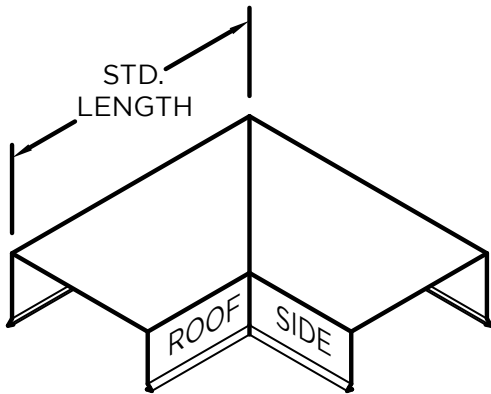

OUTSIDE MITER

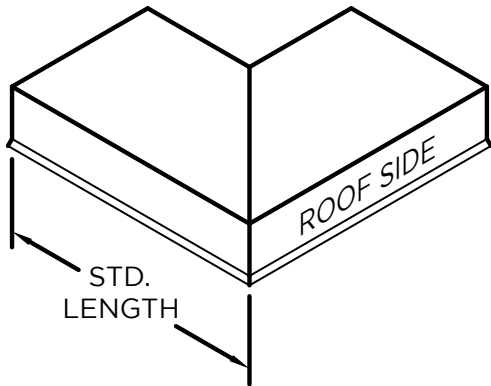

INSIDE MITER

MITER STANDARD LEG LENGTH:
 $WALL\ SIZE + 9\frac{5}{8}'' = LENGTH$

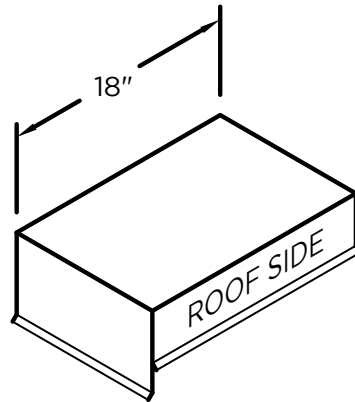

ENDCAP
 (LEFT HAND SHOWN)

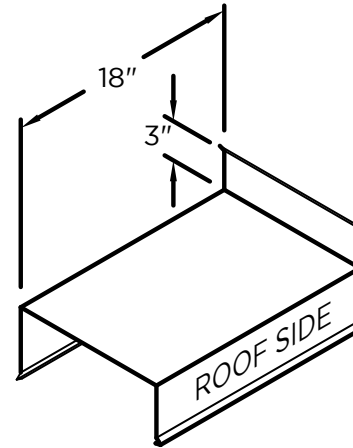

ENDWALL FLASHING
COPING VERSION
 (RIGHT HAND SHOWN)

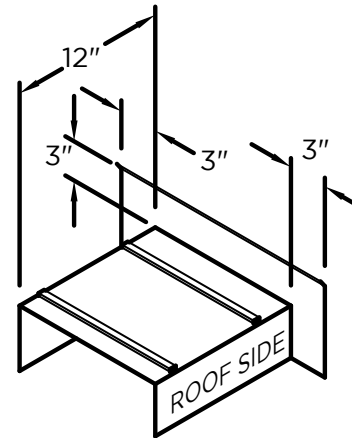

ENDWALL FLASHING
SPLICE PLATE VERSION
 (RIGHT HAND SHOWN)
 (AVAILABLE ONLY IN
 .040" WELDED, PAINTED
 TO MATCH COPING)

NOTES

Additional accessories are available including:

- Transition Miters
- Straight Transition Miters
- "T" Miters
- "Z" Miters
- Step-up Miters
- Peak / Valley Miters
- Pilaster Caps
- Radius Coping
- Arched Coping

For additional accessory requirements, attach sketches or call manufacturer for assistance.

SHT# ____ of ____

DATE: **03/21/24**

DRN BY: **JJC**

CKD BY: **MM**

DWG #: 52011-42334

REV: **A**

Mule-Hide Products
 1195 Prince Hall Drive
 Beloit, WI 53511
 800-786-1492
 www.mulehide.com

To submit a quote request, please contact your local TM or email mhquotes@metalera.com.