



Description:

Flat coping offers a complete and attractive finish to any parapet wall. The system rests flat on top of the parapet. A continuous cleat secures the front and the back is secured by a screw.

- Fabricated 10 foot lengths; widths are customized to specification.
- 6" concealed splice plate provides coverage for expansion and contraction.
- Continuous cleat is fabricated from 22 or 24 gauge galvanized or .050 aluminum.
- Riveted inside and outside miters and end caps are available.

Contact Mule-Hide to request a color chart, samples and information regarding custom metals and finishes.

Energy Efficiency:

LEED® and ENERGY STAR® compliant; 100% recyclable.

Installation:

1. A wood nailer attached to the top of the parapet wall is required.
2. This nailer should be attached to the wall in accordance with ANSI/SPRI ES-1 3.9.
3. Install the flat coping in accordance with Mule-Hide Detail #MHSM-6050.
4. Any deviation from the requirements set forth in the detail drawings must be pre-approved, in writing, by the Mule-Hide Technical Department.

Warranty:

Mule-Hide metal accessories are eligible for warranty coverage when properly installed as part of a Standard or Premium warrantable system. Please visit our Web site or call us for more information.

Technical Services:

Product samples, detail sheets, color chips, and color chart are available for your submittal package. For assistance with questions or submittals, contact your local representative or call Mule-Hide.

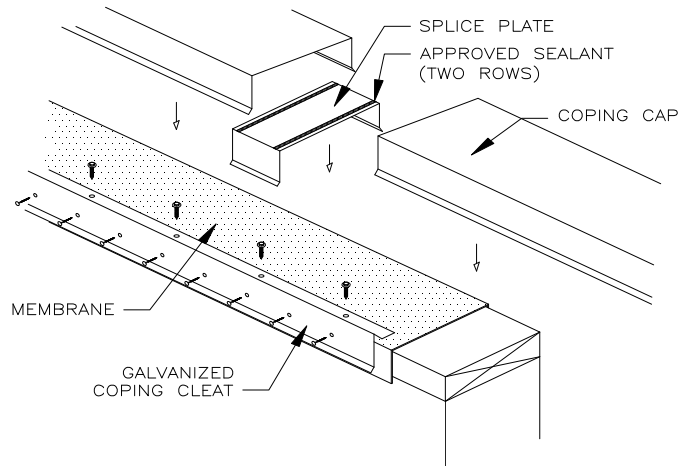
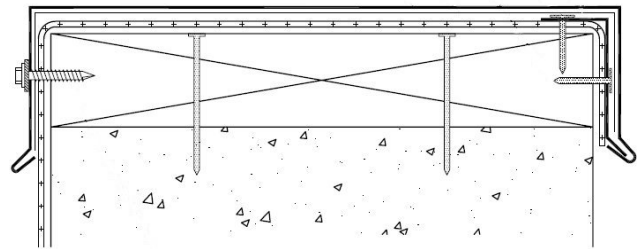

| Material | Gauge | Finish |
|------------------|-------------|----------------|
| Aluminum | .040 / .050 | Mill or Kynar® |
| Stainless Steel | 24-gauge | N/A |
| Bonderized Steel | 24-gauge | N/A |
| Galvalume | 24-gauge | Mill or Kynar® |
| Copper | 16 oz. | Mill |