



## Product Data Sheet 2-Piece Snap-On Compression

### Description:

The 2-Piece Snap-On Compression system may be used as a perimeter flashing in a Mule-Hide PVC, TPO, or EPDM roofing system. The system consists of a 24-gauge Galvalume® base and a snap-on metal cover.

- Base and cover is fabricated in 10' lengths; 3" – 8" widths. Manufactured from various metals (see chart below).
- Cover is double-hemmed to protect roof material from excessive wear.
- Installs on 2/12 pitch and lower.
- Ready to assemble inside and outside corners are available.

Contact Mule-Hide to request a color chart, samples and information regarding custom metals and finishes.

### Energy Efficiency:

LEED® and ENERGY STAR® compliant; 100% recyclable.

### Installation:

1. A wood nailer is required.
2. This nailer should be attached to the wall in accordance with ANSI/SPRI ES-1 3.9.
3. Install in accordance with Mule-Hide detail drawings.
4. Any deviation from the requirements set forth in the detail drawings must be pre-approved, in writing, by the Mule-Hide Technical Department.

### Codes and Standards:

- ANSI/SPRI ES-1 Compliant with 3" – 8" base and cover.
- Meets TAS 111-95 Test with 4" and 6".
- FM Approval on 4" and 6".

### Warranty:

Mule-Hide metal accessories are eligible for warranty coverage when properly installed as part of a Standard or Premium warrantable system. Please visit our Web site or call us for more information.

### Technical Services:

Product samples, detail sheets, color chips, and color chart are available for your submittal package. For assistance with questions or submittals, contact your local representative or call Mule-Hide.

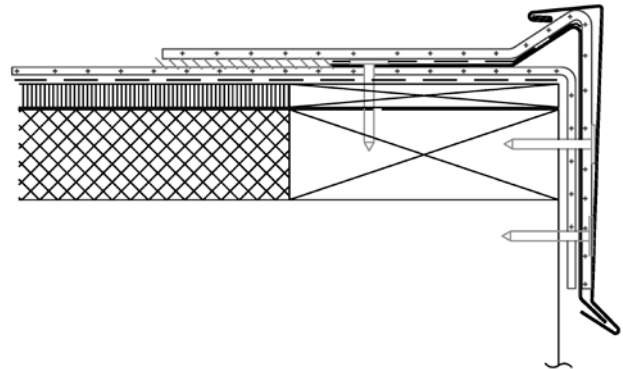

Material	Gauge	Finish
Aluminum	.040	Mill or Kynar®
Stainless Steel	24-gauge	N/A
Bonderized Steel	24-gauge	N/A
Galvalume	24-gauge	Mill or Kynar®
Copper	16 oz.	Mill