

Summary Specification

"The name trusted in roofing since 1906"



APP TORCH

15 – Year Material or System Warranty Insulated deck

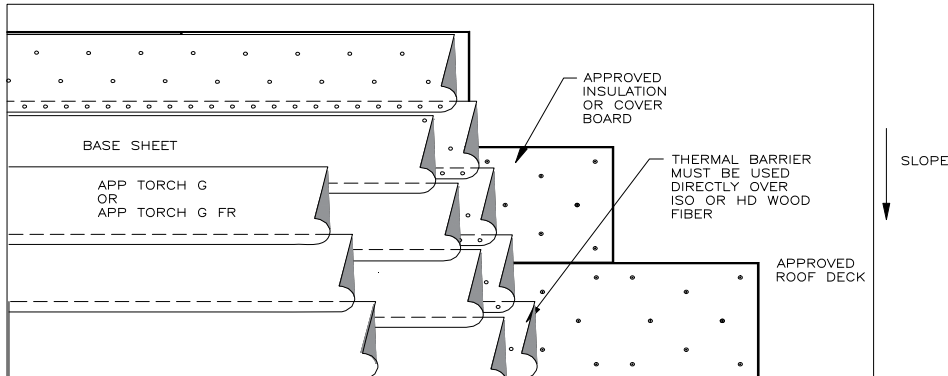

Deck Requirement
<ul style="list-style-type: none"> 2500 psi Concrete⁽¹⁾
<ul style="list-style-type: none"> 22 gauge Steel
<ul style="list-style-type: none"> Lightweight Insulation Concrete over Metal⁽²⁾
<ul style="list-style-type: none"> Min. 1" Wood Plank
<ul style="list-style-type: none"> Min 15/32" Plywood/OSB
<ul style="list-style-type: none"> Cementitious Wood Fiber⁽²⁾
<ul style="list-style-type: none"> Gypsum^{(1), (2)}

Insulation
<ul style="list-style-type: none"> Min. 1-1/2" Polyisocyanurate⁽³⁾
<ul style="list-style-type: none"> Min 1/2" HD Woodfiber⁽³⁾
<ul style="list-style-type: none"> Min. 1/2" Extruded Polystyrene⁽⁴⁾
<ul style="list-style-type: none"> Min. 1/2" Expanded Polystyrene⁽⁴⁾
<ul style="list-style-type: none"> Min. 1" Rockwool⁽⁵⁾

Cover Board
<ul style="list-style-type: none"> Min. 1/4" Dens Deck Prime⁽⁵⁾
<ul style="list-style-type: none"> Min. 1/4" Securock⁽⁵⁾
Thermal Barrier
<ul style="list-style-type: none"> G2 Base mechanically attached
<ul style="list-style-type: none"> Nail Base mechanically attached
<ul style="list-style-type: none"> SA Base^{(6), (8)}

Slope Requirement
1/4" per foot

Base Sheet ⁽⁷⁾
<ul style="list-style-type: none"> APP Torch Base
<ul style="list-style-type: none"> SA Base

Cap Sheet
<ul style="list-style-type: none"> APP Torch G
<ul style="list-style-type: none"> APP Torch G FR

Summary Specification

"The name trusted in roofing since 1906"



Notes:

1. Insulation may be attached to deck with either mechanical fasteners, foam adhesive, or hot asphalt.
2. Pull out test are required prior to installation.
3. Approved cover board or thermal barrier must be installed over insulation.
4. Approved cover board must be installed over insulation.
5. Direct torching to insulation/cover board or mechanically attached thermal barrier is approved.
6. SA Base used as a thermal barrier is only approved over polyisocyanurate insulation. If SA Base is used, ambient temperatures must be 50° F and rising.
7. One interply layer of approved Base Sheet is required.
8. SA Base used as a thermal barrier qualifies as an interply layer.
9. Flashings are to be one layer of Cap Sheet installed in accordance with Mule-Hide Standard Details.

PRODUCTS NOT SUPPLIED BY MULE-HIDE PRODUCTS ARE NOT COVERED UNDER THE MULE-HIDE WARRANTY

PLEASE CONSULT THE MULE-HIDE WEBSITE FOR THE MOST CURRENT INFORMATION AT WWW.MULEHIDE.COM