

LOW PARAPET WALL FLASHING HEIGHT NOT TO EXCEED 24"

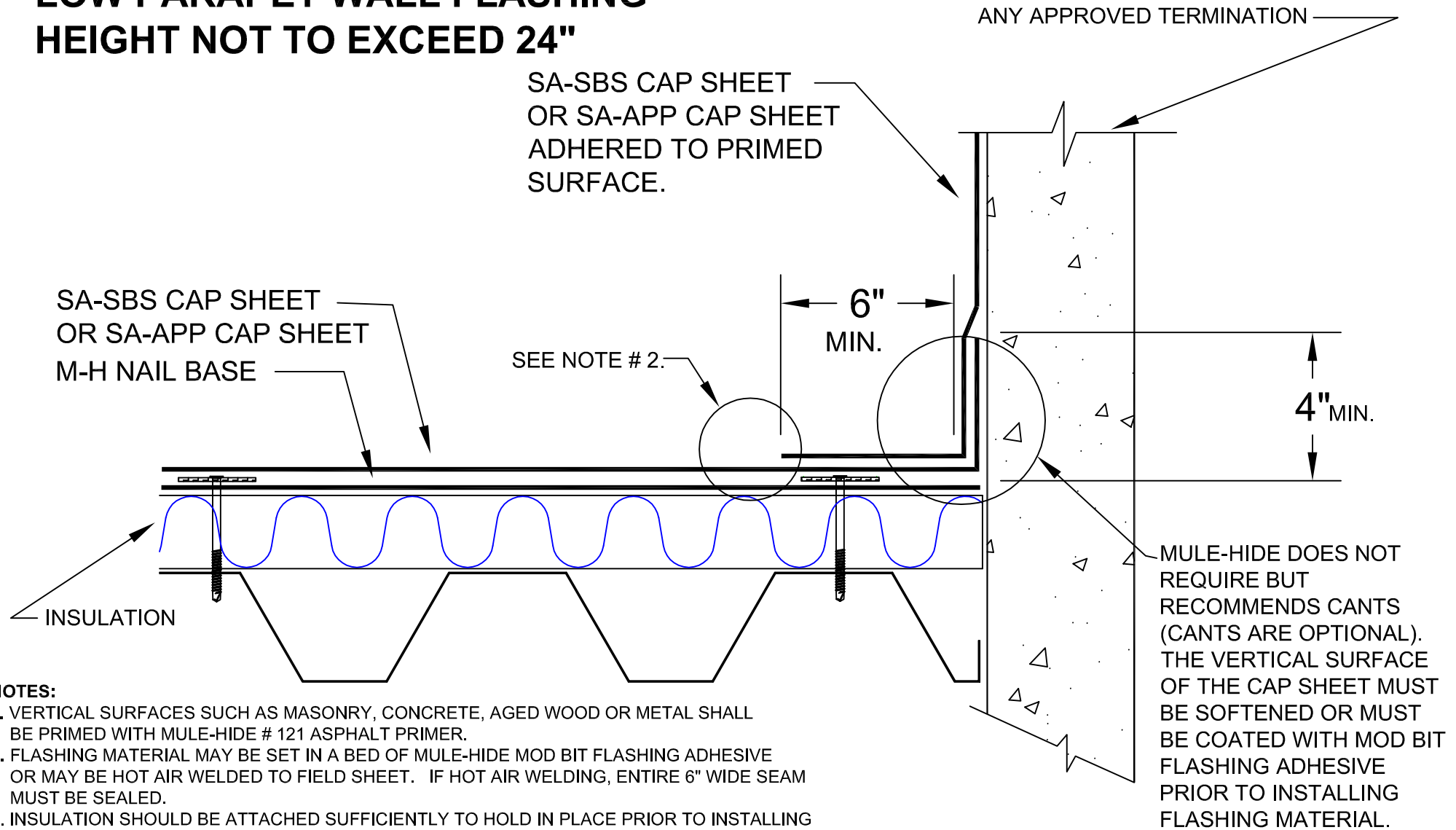

NOTES:

1. VERTICAL SURFACES SUCH AS MASONRY, CONCRETE, AGED WOOD OR METAL SHALL BE PRIMED WITH MULE-HIDE # 121 ASPHALT PRIMER.
2. FLASHING MATERIAL MAY BE SET IN A BED OF MULE-HIDE MOD BIT FLASHING ADHESIVE OR MAY BE HOT AIR WELDED TO FIELD SHEET. IF HOT AIR WELDING, ENTIRE 6" WIDE SEAM MUST BE SEALED.
3. INSULATION SHOULD BE ATTACHED SUFFICIENTLY TO HOLD IN PLACE PRIOR TO INSTALLING THE NAIL BASE.
4. NAIL BASE SHALL BE MECHANICALLY ATTACHED IN COMPLIANCE WITH FM ATTACHMENT GUIDELINES. THE MINIMUM ATTACHMENT PATTERN IS FM 1-60. REFER TO DETAIL: MH-MB-NB-FM 1-60.

MULE-HIDE DOES NOT REQUIRE BUT RECOMMENDS CANTS (CANTS ARE OPTIONAL). THE VERTICAL SURFACE OF THE CAP SHEET MUST BE SOFTENED OR MUST BE COATED WITH MOD BIT FLASHING ADHESIVE PRIOR TO INSTALLING FLASHING MATERIAL.

**MULE-HIDE
PRODUCTS CO.,INC.
2014**

**BASE FLASHING - OPTION 3
SELF-ADHERING MOD BIT SYSTEMS**

**DETAIL NO.:
MH-MB-BF3**