

LOW PARAPET WALL FLASHING HEIGHT NOT TO EXCEED 24"

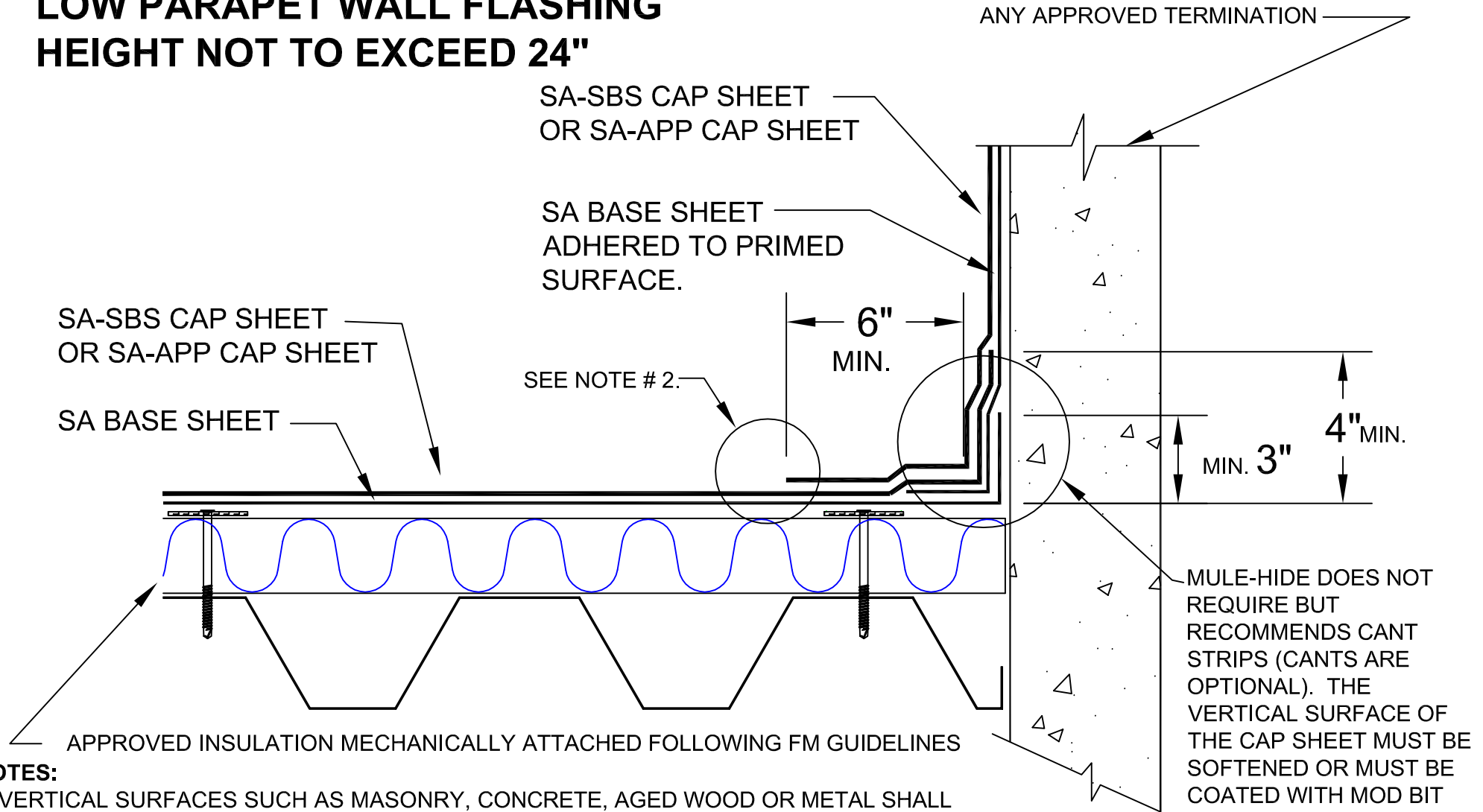

SA-SBS CAP SHEET
OR SA-APP CAP SHEET

SA BASE SHEET
ADHERED TO PRIMED
SURFACE.

ANY APPROVED TERMINATION

SA-SBS CAP SHEET
OR SA-APP CAP SHEET

SA BASE SHEET

6"
MIN.

SEE NOTE # 2.

MIN. 3"

4"
MIN.

APPROVED INSULATION MECHANICALLY ATTACHED FOLLOWING FM GUIDELINES

MULE-HIDE DOES NOT REQUIRE BUT RECOMMENDS CANT STRIPS (CANTS ARE OPTIONAL). THE VERTICAL SURFACE OF THE CAP SHEET MUST BE SOFTENED OR MUST BE COATED WITH MOD BIT FLASHING ADHESIVE PRIOR TO INSTALLING FLASHING MATERIAL.

NOTES:

- 1. VERTICAL SURFACES SUCH AS MASONRY, CONCRETE, AGED WOOD OR METAL SHALL BE PRIMED WITH MULE-HIDE # 121 ASPHALT PRIMER.
- 2. FLASHING MATERIAL MAY BE SET IN A BED OF MULE-HIDE MOD BIT FLASHING ADHESIVE OR MAY BE HOT AIR WELDED TO FIELD SHEET. IF HOT AIR WELDING, ENTIRE 6" WIDE SEAM MUST BE SEALED.

**MULE-HIDE
PRODUCTS CO.,INC.
2003**

BASE FLASHING - OPTION 2

SELF-ADHERING MOD BIT SYSTEMS

**DETAIL NO.:
MH-MB-BF2**