

NOTES:

1. CUT THE MEMBRANE SO IT EXTENDS A MINIMUM OF 1/2" FROM THE ATTACHMENT POINTS OF THE DRAIN CLAMPING RING.
2. THE CLAMPING RING BOLT MUST PENETRATE THE MEMBRANE.
3. ALL FLASHINGS ON A TPO FLEECEBACK PROJECT MUST BE CONSTRUCTED WITH STANDARD REINFORCED TPO MEMBRANE.
4. APPROXIMATELY 1/8" BEAD OF CUT-EDGE SEALANT IS REQUIRED ON CUT EDGES OF TPO REINFORCED MEMBRANE.
5. THICKNESS OF STANDARD TPO MEMBRANE TO MATCH THICKNESS OF FLEECEBACK TPO MEMBRANE.

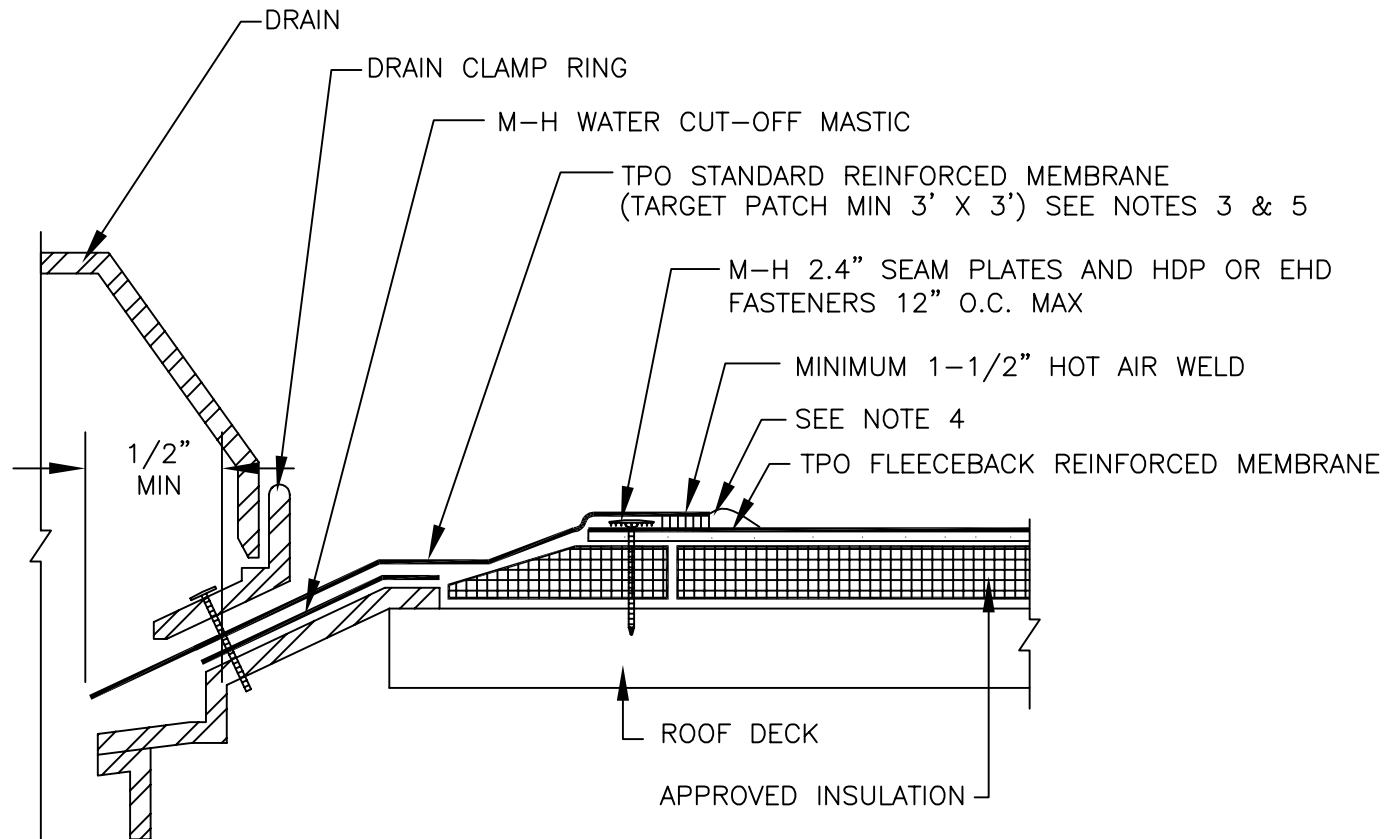

**MULE-HIDE
PRODUCTS CO., INC.**

**DRAIN FLASHING
WITH TARGET
SYSTEMS:
MECHANICALLY ATTACHED
TPO FLEECE BACK**

DETAIL NO.:
MHT-MA-510C

REVISION DATE: 10/2013