

NOTES:

1. DETAILS TO BE USED IN CONJUNCTION WITH STANDARD GUIDE SPECIFICATIONS CONTAINING REQUIREMENTS FOR NAILERS, INSULATION, SLIPSHEETS, ETC.

2. PVC EDGE SEALANT IS REQUIRED ON ALL CUT OR NON-ENCAPSULATED EDGES OF REINFORCED MEMBRANE. THIS INCLUDES FACTORY CUT MEMBRANE.

3. FOR COATED METAL JOINT SEE MULE-HIDE DETAIL MHP-109.

4. APPLICATOR/SPECIFIER TO DETERMINE HEIGHT REQUIRED TO PREVENT WATER FROM CASCADING OVER BUILDING EDGE.

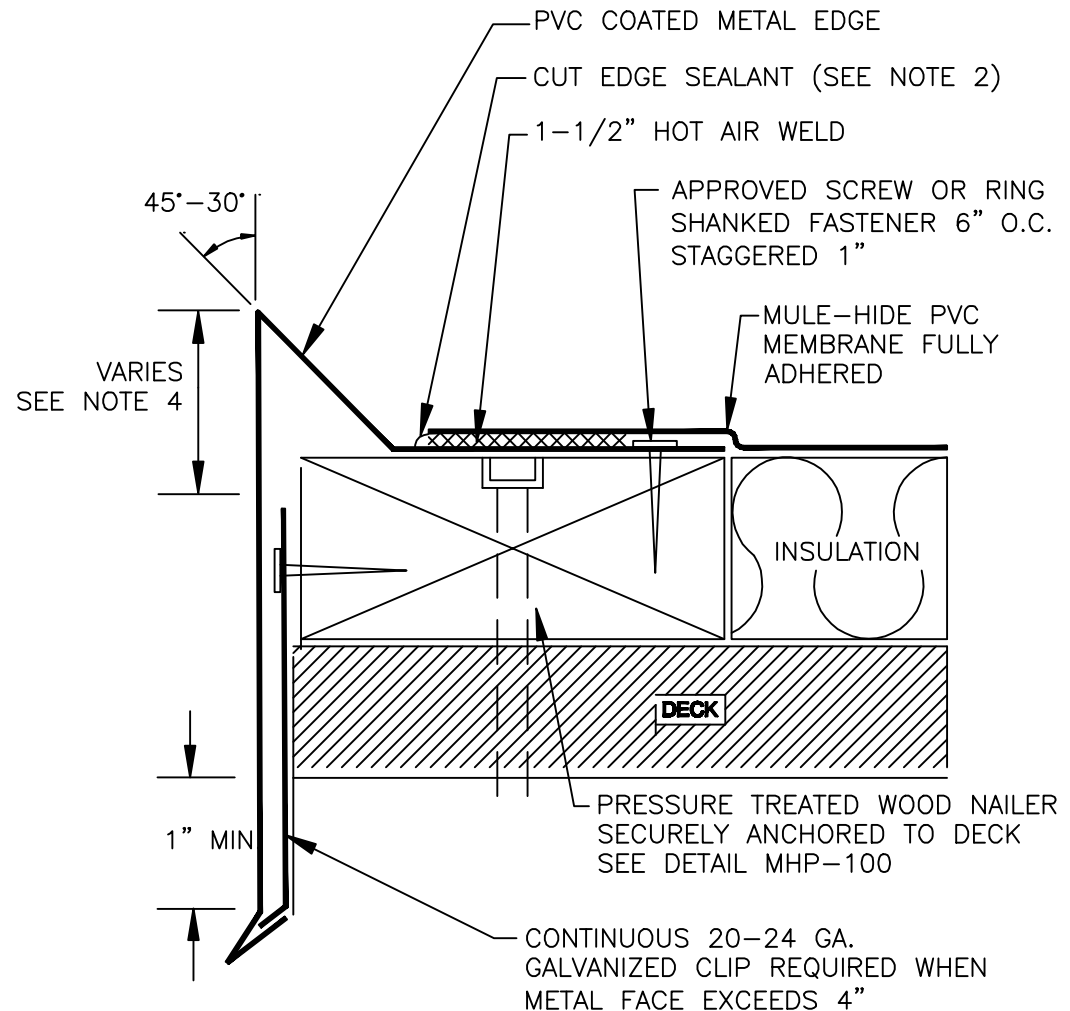

**MULE-HIDE
PRODUCTS CO., INC.
04/01/2007**

**PVC COATED METAL GRAVEL STOP
SYSTEMS:
FULLY ADHERED PVC**

**DETAIL NO:
MHP-101**