

THE ATTACHMENT PATTERN SHOWN IS THE STANDARD PATTERN FOR FIELD ATTACHMENT REQUIRED BY MULE-HIDE. THE ATTACHMENT IN THE PERIMETER AREA IS INCREASED 50% AND 75% IN THE CORNERS.

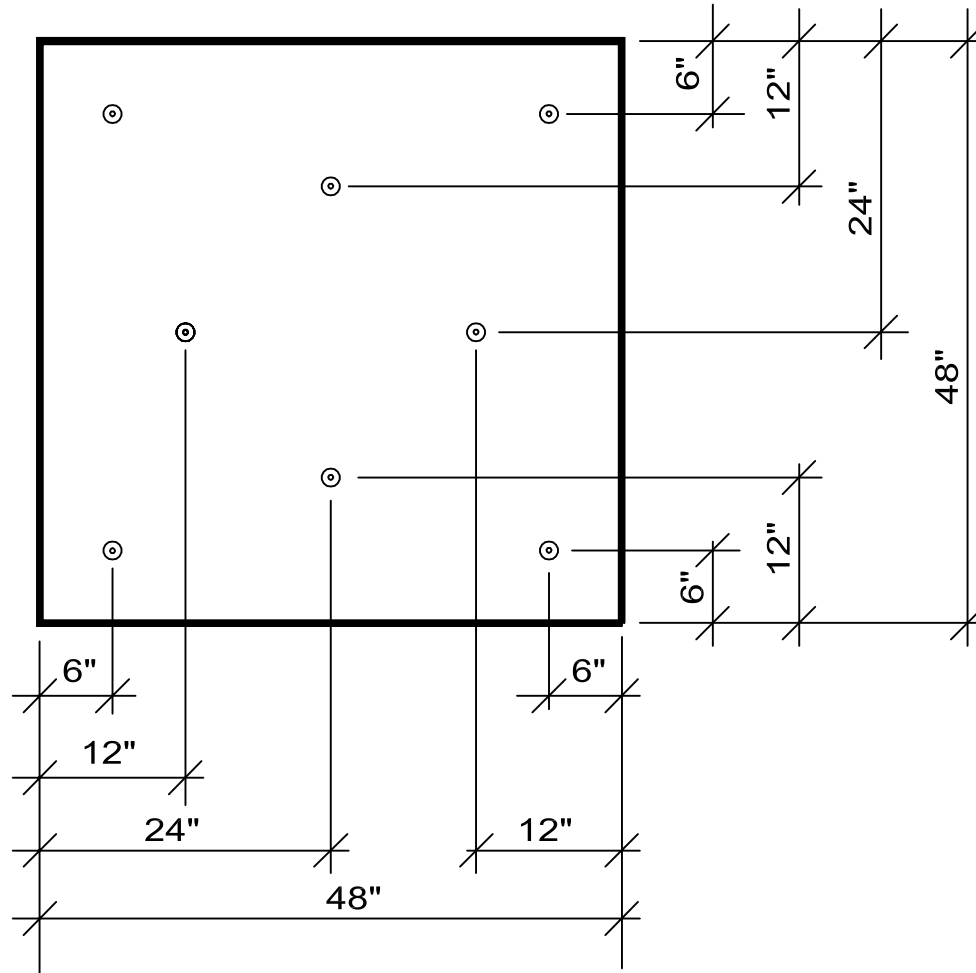

4' X 4' INSULATION ATTACHMENT (1 PER 2 SF.)  
STANDARD ATTACHMENT

**MULE-HIDE**  
**PRODUCTS CO.,INC.**  
2003

**INSULATION ATTACHMENT - OPTION 2**

**SELF-ADHERING MOD BIT SYSTEMS**

**DETAIL NO.:**  
**MH-MB-INS-2**