

MULE-HIDE SELF-ADHERING MEMBRANE SYSTEM

LEAD FLASHING SET IN SOFTENED CAP SHEET OR SET IN A BED OF MULE-HIDE MOD BIT FLASHING ADHESIVE

IF NOT USING FLASHING ADHESIVE, CAP FLASHING MATERIAL MUST BE HOT AIR WELDED TO FIELD SHEET

EXTEND FLASHING MATERIAL 4" (MIN.) BEYOND LEAD FLANGE

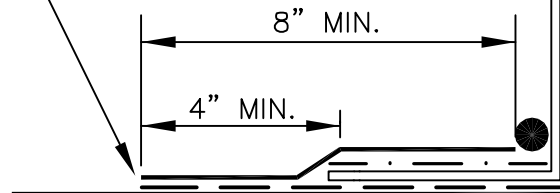

MULE-HIDE SA CAP SHEET
MULE-HIDE SA BASE SHEET
OR MULE-HIDE NAIL BASE

MULE-HIDE MOD BIT SEALANT

MULE-HIDE CAP SHEET FLASHING MATERIAL

PRIME LEAD SURFACE WITH MULE-HIDE # 121 ASPHALT PRIMER OR FAST DRY PRIMER MEETING ASTM D41

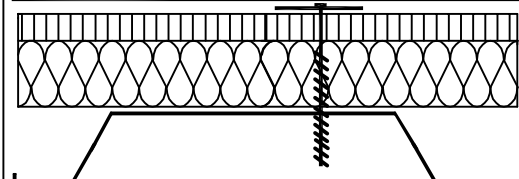
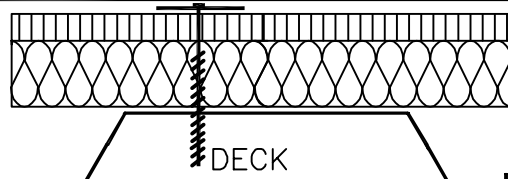
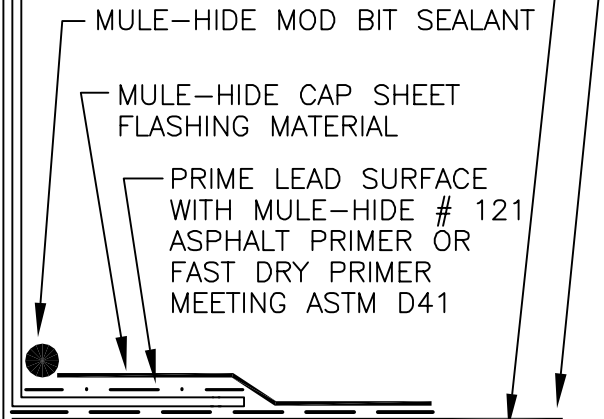

INSULATION MUST BE MECHANICALLY ATTACHED TO THE DECK USING APPROPRIATE FASTENERS FOR THE DECK TYPE. NON-APPROVED INSULATION SHALL REQUIRE AN APPROVED COVER BOARD OR THE INSTALLATION OF MULE-HIDE'S NAIL BASE. IF USING NAIL BASE, FOLLOW FM ATTACHMENT PATTERN FOR BASE SHEET ATTACHMENTS.

MULE-HIDE
PRODUCTS CO.,INC.
2003

PIPE FLASHING - OPTION 5
SELF-ADHERING MOD BIT SYSTEMS

DETAIL NO.:
MH-MB-P5