

PERIMETER EDGE METAL SHALL BE PRIMED WITH MULE-HIDE # 121 ASPHALT PRIMER OR FAST DRY PRIMER IN AEROSOL CAN MEETING ASTM D 41.

1" [25 mm] MIN.  
BELOW BLOCKING

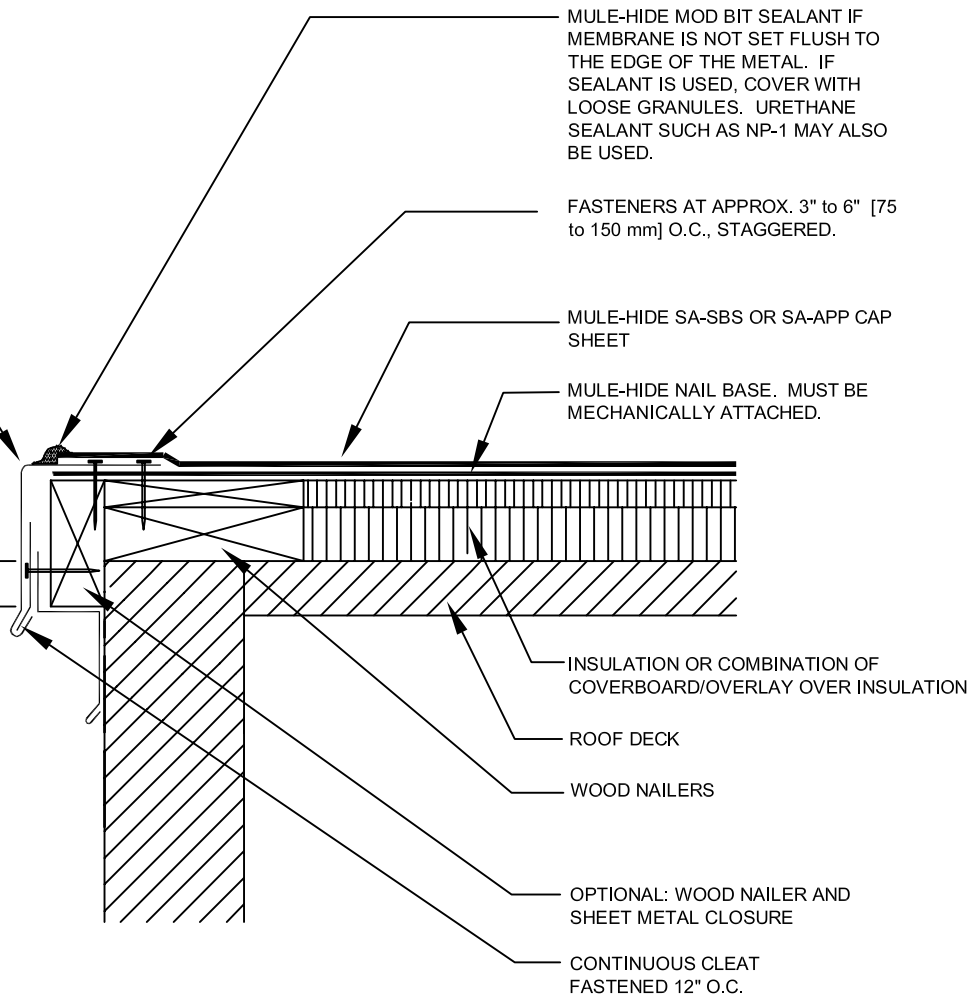

**NOTES:**

1. THIS DETAIL SHOULD BE USED ONLY WHERE THE DECK IS SUPPORTED BY THE OUTSIDE WALL.
2. REFER TO THE SHEET METAL SECTION OF THE NRCA ROOFING AND WATERPROOFING MANUAL FOR JOINERY AND SECUREMENT OPTIONS FOR SHEET METAL.

**MULE-HIDE  
PRODUCTS CO.,INC.  
2003**

**EDGE METAL FLASHING - OPTION 4**

**SELF-ADHERING MOD BIT SYSTEMS**

**DETAIL NO.:  
MH-MB-EM4**