

NOTES:

1. IF THE EDGE EXTENDER IS 4" OR LARGER, A CONTINUOUS CLEAT IS REQUIRED.
2. THE CONTINUOUS CLEAT AND EDGE EXTENDER MUST BE FASTENED 6" ON CENTER MAX.
3. ALL JOINTS AND SPLICES MUST BE STAGGERED A MINIMUM OF 12".
4. PLACE BEAD OF WATER CUT-OFF ON BACK OF FASCIA BAR PRIOR TO INSTALLATION.
5. USE STAINLESS STEEL FASTENERS WHEN ATTACHING INTO ACQ TREATED WOOD.
6. THE METAL EDGE EXTENDER CAN BE USED ON ANY PERIMETER EDGE METAL DETAIL.

NOTE:

THIS DETAIL IS NOT INCLUDED IN ANY MULE-HIDE LABOR AND MATERIAL WARRANTY

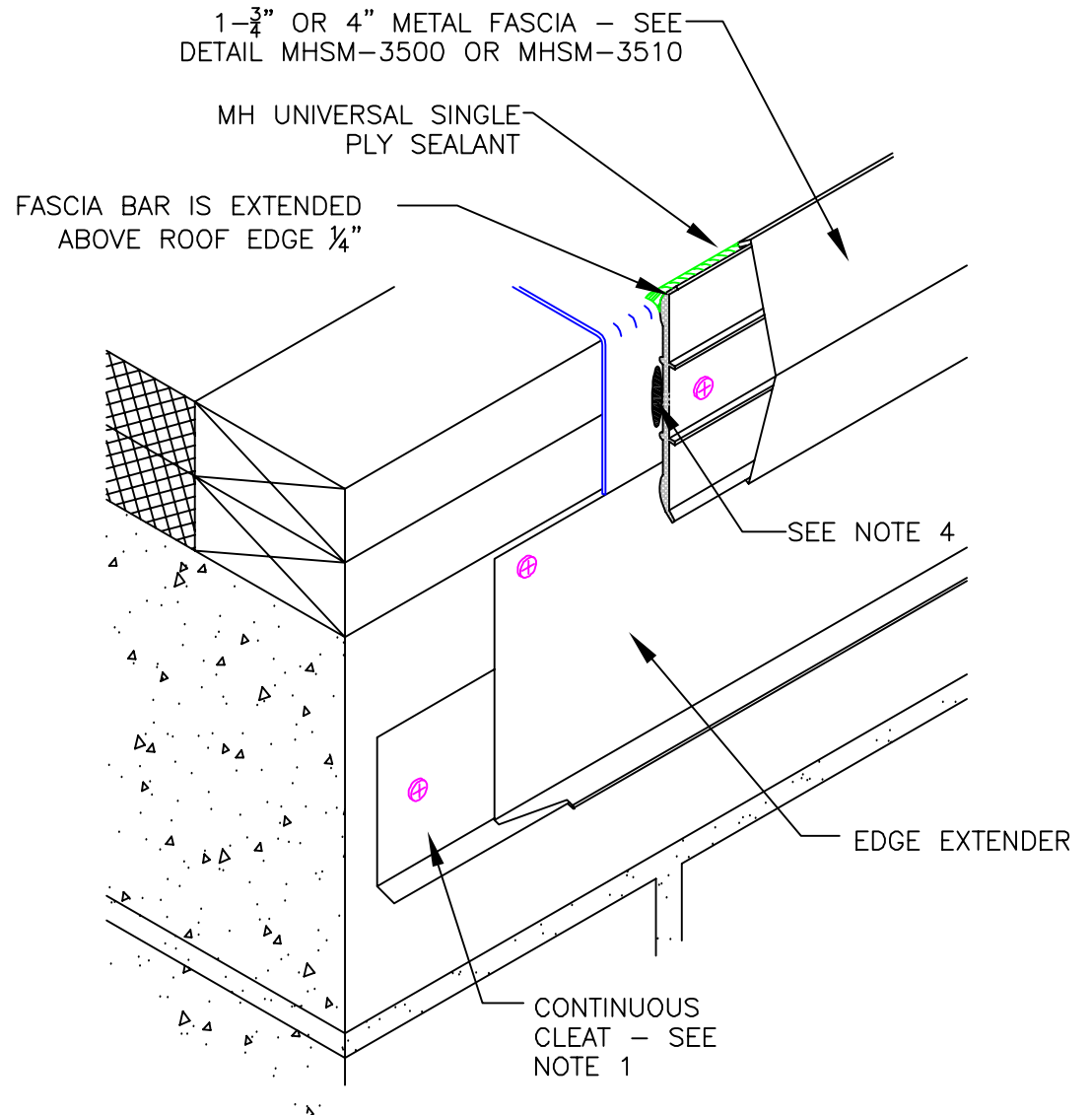

**MULE-HIDE
PRODUCTS CO., INC.**

**MULE-HIDE PREMANUFACTURED
METAL EDGE EXTENDER
SYSTEMS:
ALL MULE-HIDE SYSTEMS**

DETAIL NO.:
MHSM-3540

REVISION DATE: 01/2013