

NOTES:

1. DETAILS TO BE USED IN CONJUNCTION WITH STANDARD GUIDE SPECIFICATIONS CONTAINING REQUIREMENTS FOR NAILERS, INSULATION, SLIP SHEETS, ETC.
2. TERMINATION BAR MUST BE INSTALLED TO HARD, SMOOTH NON-POROUS SUBSTRATE.
3. DO NOT APPLY TERMINATION CAULK OVER ASPHALT OR OTHER MATERIALS THAT WILL PREVENT PROPER ADHESION.
4. TERMINATION BAR MUST BE CUT AT EACH WALL JOINT

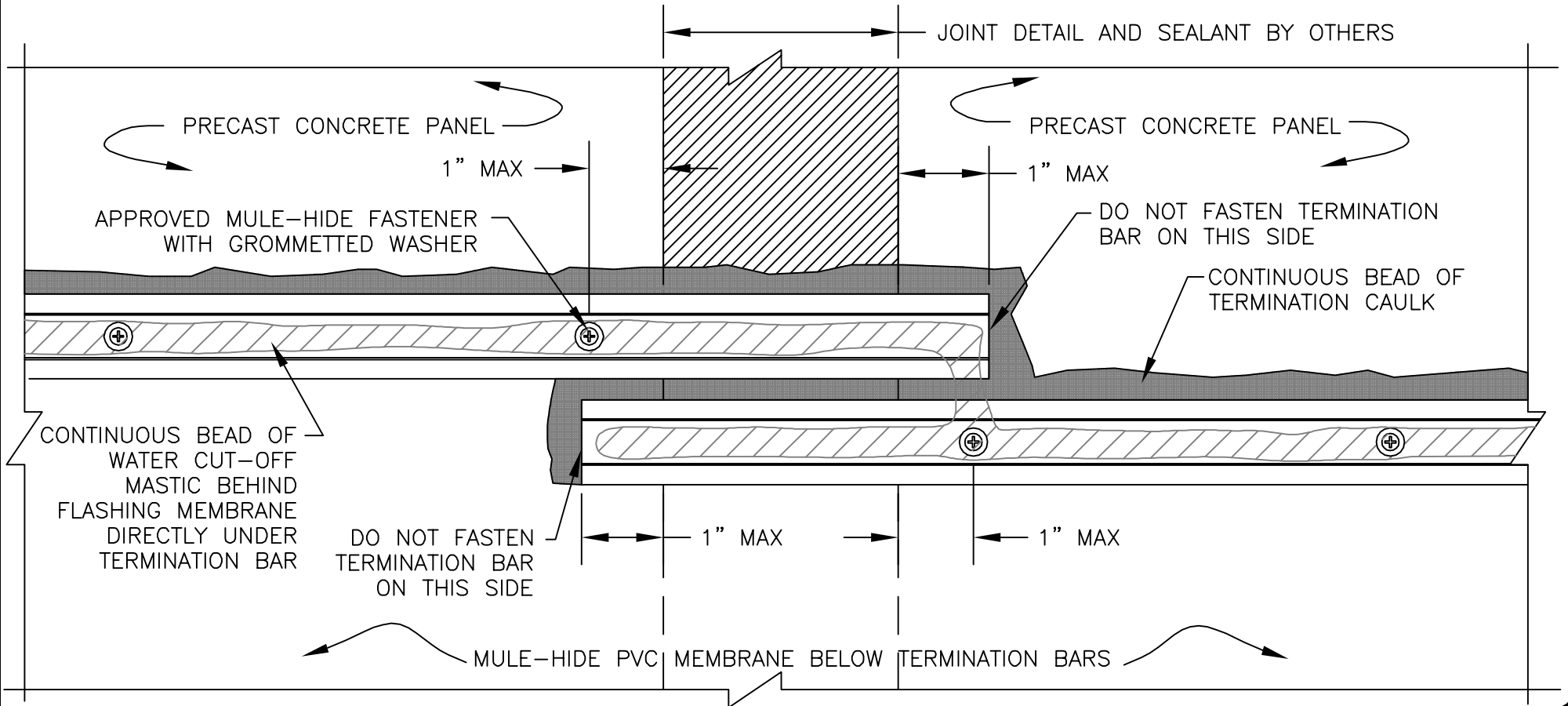

**MULE-HIDE  
PRODUCTS CO., INC.**  
04/01/2007

**TERMINATION BAR  
AT TILT-UP WALL JOINT  
SYSTEMS:  
ALL PVC**

**DETAIL NO:  
MHP-197**